



Bleak Street
Bolton

Miller Metcalfe
Every step of the way

Bleak Street

Bolton

Semi Detached



3



1

EPC Rating - D

RENOVATED THROUGHOUTNO ONWARD CHAIN***THREE BEDROOMS***

Semi-detached family home situated in a cul de sac position in a popular location close to many local amenities and Bolton town centre. The property has undergone a complete renovation by the current owner and internal viewing is essential to fully appreciate. The property is being offered for sale with no onward chain.

Accommodation briefly comprising of an open plan lounge with built in surround sound ceiling speakers, dining area and recently fitted modern kitchen with underfloor heating. Rising to the first floor are three bedrooms and a modern shower room. Outside are gardens to the front and rear.

The property is heated by a gas central heating system and is double glazed.

TENURE

Freehold

LOCAL AUTHORITY/COUNCIL TAX

Bolton

Band: A

Annual Price: £1,306 approx

SATELLITE / FIBRE TV AVAILABILITY

BT

Sky

Virgin

BROADBAND

Basic: 12 Mbps

Superfast: 80 Mbps

Ultrafast: 1000 Mbps

MOBILE COVERAGE

EE - low

Vodafone - high

Three - low

O2 - high

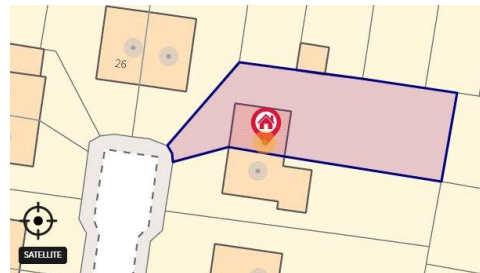



GROUND FLOOR
435 sq.ft. (40.4 sq.m.) approx.

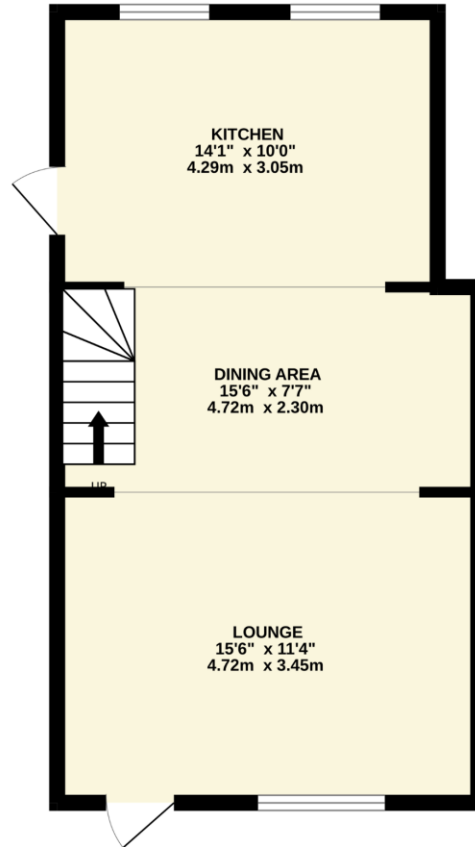

1ST FLOOR
293 sq.ft. (27.3 sq.m.) approx.

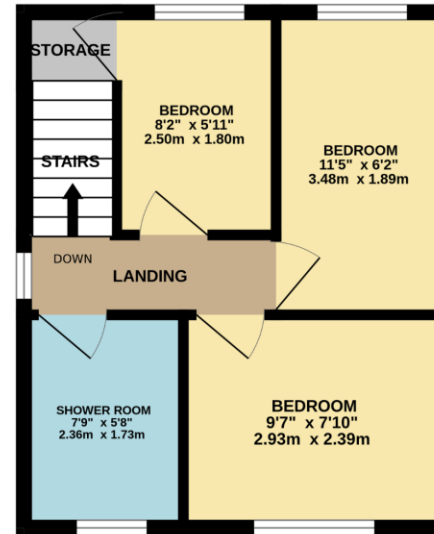

TOTAL FLOOR AREA : 728 sq.ft. (67.6 sq.m.) approx.

Whilst every attempt has been made to ensure the accuracy of the floorplan contained here, measurements of doors, windows, rooms and any other items are approximate and no responsibility is taken for any error, omission or mis-statement. This plan is for illustrative purposes only and should be used as such by any prospective purchaser. The services, systems and appliances shown have not been tested and no guarantee as to their operability or efficiency can be given.
Made with Metropix ©2023

Every attempt has been made to ensure accuracy, however these property particulars are approximate and for illustrative purposes only. They have been prepared in good faith and they are not intended to constitute part of an offer of contract. We have not carried out a structural survey and the services, appliances and specific fittings have not been tested. All photographs, measurements, floor plans and distances referred to are given as a guide only and should not be relied upon for the purchase of any fixture or fittings. Lease details, service charges and ground rent (where applicable) are given as a guide only and should be checked prior to agreeing a sale.