



Brookside Crescent

Greenmount

Miller Metcalfe
Every step of the way

Brookside Crescent

Greenmount

Semi Detached



3



1

EPC Rating - D

**** BEAUTIFULLY PRESENTED HOME AVAILABLE IMMEDIATELY WITH NO ONWARD CHAIN ****

We are so excited to welcome to the market this well appointed three bedroom semi-detached home which is located in a hugely sought after spot in Greenmount! The property, which is neutrally decorated throughout in ready to move straight into and enjoy from day one. We think it would be perfect for a growing family looking to upsize.

Take advantage of two reception rooms, a separate kitchen, three generous bedrooms and a fully fitted family bathroom suite. Number 18 sits on a generous plot and benefits from plenty of parking plus well kept gardens to the front and rear.

Accommodation briefly comprises; entrance porch with a door leading to a bright and airy lounge area. Adjacent is another reception room which could be used as a dining space and is adjacent to a fitted kitchen with a combination of base and eye level units. Take the stairs to the first floor and you'll find two double bedrooms, a further single bedroom with a family bathroom suite with separate WC.

SATELLITE / FIBRE TV AVAILABILITY

BT
Sky

TENURE

Leasehold
999 years from 1960

LOCAL AUTHORITY & COUNCIL TAX

Bury Council
Band C
Annual Price: £1842

MOBILE COVERAGE

EE
Vodafone
Three
O2

BROADBAND

Broadband

Basic 17 Mbps
Superfast 56 Mbps





GROUND FLOOR
486 sq.ft. (45.1 sq.m.) approx.

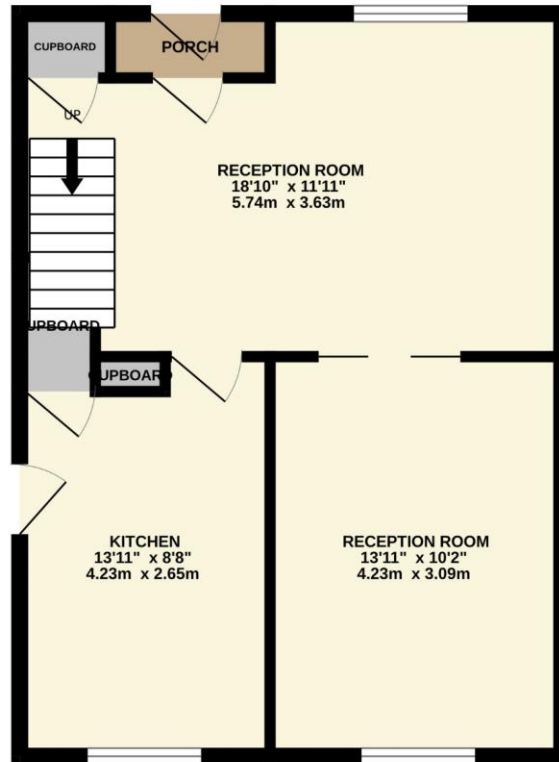

1ST FLOOR
486 sq.ft. (45.1 sq.m.) approx.

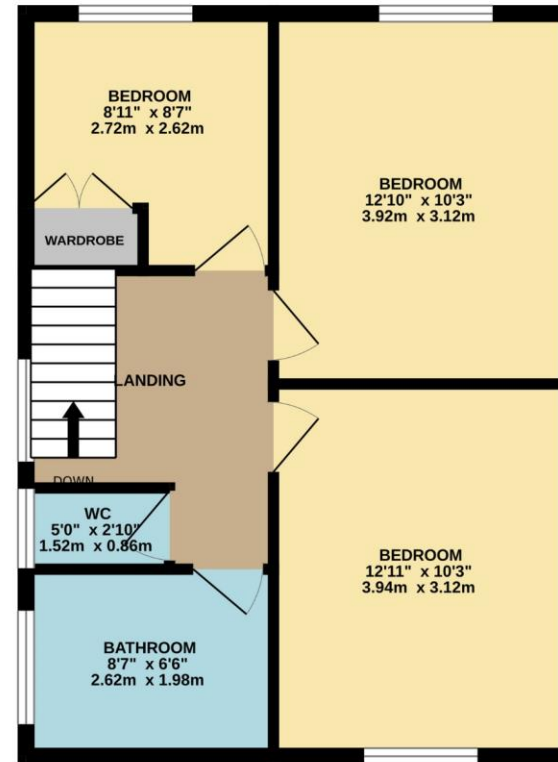

TOTAL FLOOR AREA : 971 sq.ft. (90.2 sq.m.) approx.

Whilst every attempt has been made to ensure the accuracy of the floorplan contained here, measurements of doors, windows, rooms and any other items are approximate and no responsibility is taken for any error, omission or mis-statement. This plan is for illustrative purposes only and should be used as such by any prospective purchaser. The services, systems and appliances shown have not been tested and no guarantee as to their operability or efficiency can be given.
Made with Metropix ©2024

Every attempt has been made to ensure accuracy, however these property particulars are approximate and for illustrative purposes only. They have been prepared in good faith and they are not intended to constitute part of an offer of contract. We have not carried out a structural survey and the services, appliances and specific fittings have not been tested. All photographs, measurements, floor plans and distances referred to are given as a guide only and should not be relied upon for the purchase of any fixture or fittings. Lease details, service charges and ground rent (where applicable) are given as a guide only and should be checked prior to agreeing a sale.