



Carron Grove
Brightmet

Miller Metcalfe
Every step of the way

Carron Grove

Brightmet

Semi Detached



EPC Rating - To be confirmed

Introducing this charming true semi detached bungalow boasting a convenient location in a sought - after neighbourhood. This property offers two well appointed bedrooms, ideal for a downsizer of home, or with the large loft area could provide additional accommodation with the appropriate planning permission.. The interior is thoughtfully designed with a cosy living space and modern kitchen, creating a comfortable atmosphere. The property has full gas central heating and is completely double glazed with easily maintained gardens to the rear and front of the bungalow. In addition, it benefits from off-street parking and a garage, providing ample space for vehicles and storage. With easy access to local amenities , shops, transport links and schools, this property presents an excellent opportunity for those looking for a well- maintained home in a quiet cul - de - sac in a desirable area. Don't miss out on the chance to make this delightful bungalow your own.

LOCAL AUTHORITY/COUNCIL TAX

Bolton
Band B Annual Cost £1,524

TENURE

Leasehold
Lease term 1000 years from 20/10/1960
Lease term remaining 937 years
Lease end date 21/10/2960

SATELLITE/FIBRE TV AVAILABILITY

BT
Sky
Virgin

BROADBAND

Basic: 5 MBPS
Superfast: 80 MBPS
Ultrafast: 1000 MBPS





GROUND FLOOR
566 sq.ft. (52.6 sq.m.) approx.

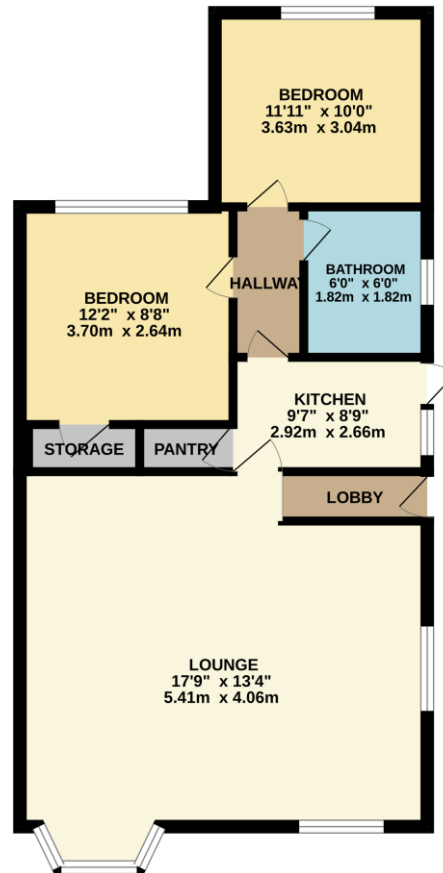

TOTAL FLOOR AREA: 566 sq.ft. (52.6 sq.m.) approx.

Whilst every attempt has been made to ensure the accuracy of the floorplan contained here, measurements of doors, windows, rooms and any other items are approximate and no responsibility is taken for any error, omission or mis-statement. This plan is for illustrative purposes only and should be used as such by any prospective purchaser. The services, systems and appliances shown have not been tested and no guarantee as to their operability or efficiency can be given.
Made with Metropix ©2024

Every attempt has been made to ensure accuracy, however these property particulars are approximate and for illustrative purposes only. They have been prepared in good faith and they are not intended to constitute part of an offer of contract. We have not carried out a structural survey and the services, appliances and specific fittings have not been tested. All photographs, measurements, floor plans and distances referred to are given as a guide only and should not be relied upon for the purchase of any fixture or fittings. Lease details, service charges and ground rent (where applicable) are given as a guide only and should be checked prior to agreeing a sale.